

EIAJ RC5320A TYPE1

電圧区分1 適合品

RATING 定 格 : DC3.15V 2A

### No.MP-201

2.35 × 0.7 DC PLUG  
EIAJ RC5320A TYPE1 電圧区分1  
(DC 3.15V Max)

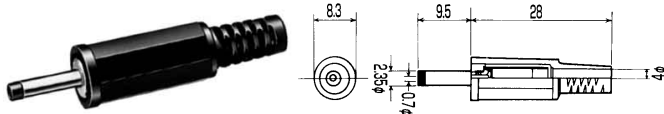

### No.MP-201LN

2.35 × 0.7 DC PLUG  
EIAJ RC5320A TYPE1 電圧区分1  
(DC 3.15V Max)

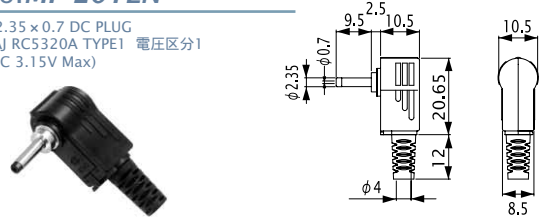

### No.MC-5321

DC ADAPTOR CABLE L=1800mm  
2.35 × 0.7  
EIAJ RC5320A TYPE1 電圧区分1  
(DC3.15V)



### No.MC-5321L

DC ADAPTOR CABLE L=1800mm  
2.35 × 0.7  
EIAJ RC5320A TYPE1 電圧区分1  
(DC3.15V)



### No.M04-446E0

DC JACK FOR P.C.B.  
PLUG TYPE: 2.35 × 0.7  
EIAJ RC5320A TYPE1 電圧区分1  
(DC 3.15V 2A)

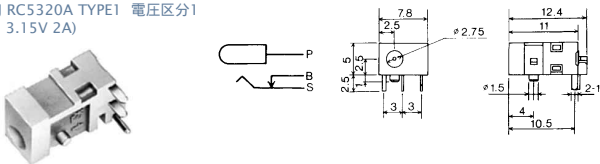

### No.M04-451DJ

DC JACK FOR P.C.B.  
PLUG TYPE: 2.35 × 0.7  
EIAJ RC5320A TYPE1 電圧区分1  
(DC 3.15V 2A)

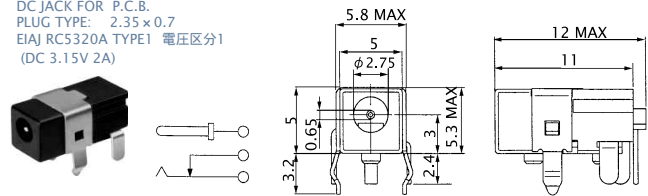

### No.M04-450DJ

DC JACK FOR P.C.B.  
PLUG TYPE: 2.35 × 0.7  
EIAJ RC5320A TYPE1 電圧区分1  
(DC 3.15V 2A)

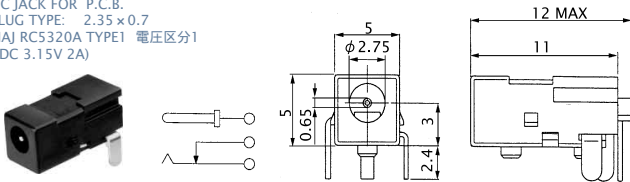

### No.M04-640SMT

DC JACK FOR P.C.B.  
PLUG TYPE: 2.35 × 0.7  
EIAJ RC5320A TYPE1 電圧区分1  
(DC 3.15V 2A)

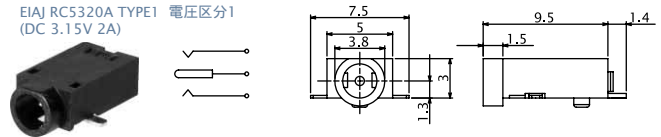

### No.M04-450SMT

DC JACK FOR P.C.B.  
PLUG TYPE: 2.35 × 0.7  
EIAJ RC5320A TYPE1 電圧区分1  
(DC 3.15V 2A)

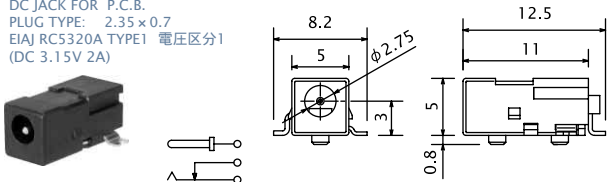

### No.M04-959A0

DC JACK FOR P.C.B.  
PLUG TYPE: 2.35 × 0.7  
EIAJ RC5320A TYPE1 電圧区分1  
(DC 3.15V 2A)

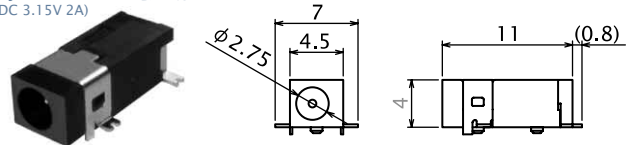

### No.M04-640DJ

DC JACK FOR P.C.B.  
PLUG TYPE: 2.35 × 0.7  
EIAJ RC5320A TYPE1 電圧区分1  
(DC 3.15V 2A)

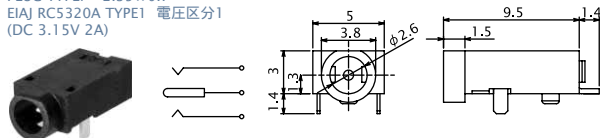

### No.M04-A18A0

DC JACK  
PLUG TYPE: 2.35 × 0.7  
EIAJ RC5320A TYPE1 電圧区分1  
(DC3.15V 2A)

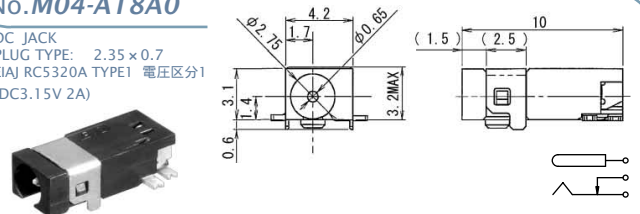

### No.MJ-095N

DC INLINE JACK  
PLUG TYPE: 2.35 × 0.7  
EIAJ RC5320A TYPE1 電圧区分1  
(DC 3.15V 2A)

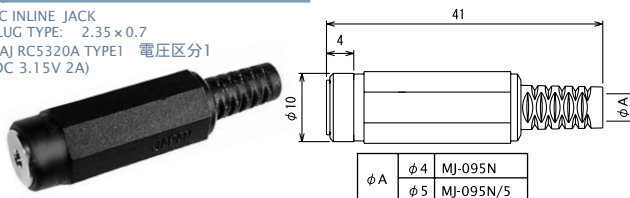

### No.MJ-16

PANEL MOUNT DC JACK  
PLUG TYPE: 2.35 × 0.7  
EIAJ RC5320A TYPE1 電圧区分1  
(DC 3.15V 2A)

